

EXPLANATION

- 10.31 ← Ground water elevation
- MW-27 ← Monitoring well location & designation
- 9.0 ← Ground water elevation contours
- ← Estimated Lateral Extent of LNAPL

NOTES

Basis of elevations is NAVD(88) as determined from Astoria Photo Control Point #42 with a published elevation of 32.91 feet.

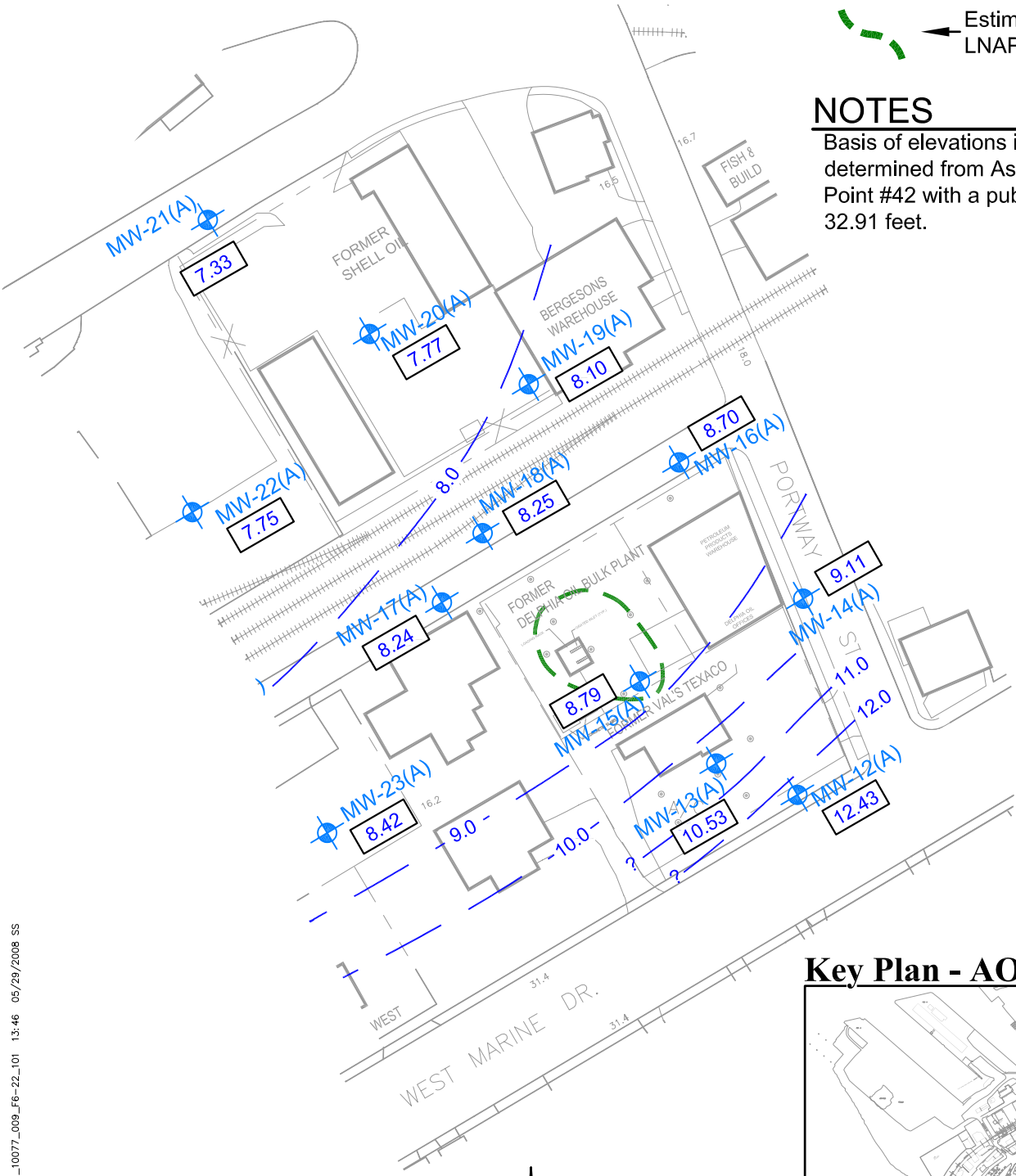

Key Plan - AOC 2



FIGURE 6-55
POTENTIOMETRIC SURFACE
AOC 2 - JULY 19, 2004
Remedial Investigation/Feasibility Study
Astoria Area-Wide Petroleum Site
Astoria, Oregon